

- Exclude any licensable activities to which the application relates
- Reject the whole or part of the application

2.1 Members of the licensing sub committee are asked to note that they may not modify the conditions or reject the whole or part of the application merely because it considers it desirable to do so. It must be appropriate in order to promote the licensing objectives.

3. Background

3.1 The premises has operated as a restaurant in the past but had its licence revoked in 2012. The premises has now come under new management and Mr Adeyemi wishes to operate a restaurant with the ability to sell alcohol.

3.2 During the consultation period letters of representation were received from a residents concerned that the hours being sought would mean the premises would operate as a night club style operation and thereby lead to noise nuisance and potential anti social behaviour in the area.

3.3 Under the Act representations can be received from responsible authorities or other persons. Representations must be relevant and, in the case of another person, must not be frivolous or vexatious.

3.4 The Licensing Authority considers that restrictions may be made to the proposed hours of use where, after receiving relevant representations, the council considers it appropriate for the promotion of the licensing objectives to do so. The council will take into account the existing pattern of licensed premises in an area when considering what is appropriate to promote the objectives. Applications which are significantly out of character for a locality will need to demonstrate that granting the hours sought will not impact on the licensing objectives, given the potential for neighbouring premises to be adversely impacted.

4. Policy Implications

4.1 The decision should be made with regard to the Secretary of the State's guidance and the Council's Statement of Licensing Policy under the Licensing Act 2003. Where the decision departs from either the Guidance or the Policy clear and cogent reasons must be given. Members should be aware that if such a departure is made the risk of appeal / challenge is increased.

4.2 Equalities impact

At the time of writing this report there were no implications for equality and diversity. Any decision taken by the Licensing Sub-Committee will be in accordance with the four licensing objectives as prescribed by the Licensing Act 2003.

5. Other considerations

5.1 Human Rights

While all Convention Rights must be considered, those which are of particular relevance to the application are:

- Article 8 – Right to respect for private and family life.
- Article 1 of the First Protocol – Protection of Property
- Article 6(1) – Right to a fair hearing.

- o Article 10 – Freedom of Expression

6 Use of Appendices

Appendix 1- Application form

Appendix 2 – Copy of Representations

Background papers: Section 82 Guidance

Haringey Statement of Licensing policy

Appendix 1 – Application From

Application for a premises licence to be granted under the Licensing Act 2003

HARINGEY COUNCIL
LICENSING
RECEIVED
21 OCT 2016



Reference number:
LK/367557

(1)

PLEASE READ THE FOLLOWING INSTRUCTIONS FIRST

Before completing this form please read the guidance notes at the end of the form. If you are completing this form by hand please write legibly in block capitals. In all cases ensure that your answers are inside the boxes and written in black ink. Use additional sheets if necessary. You may wish to keep a copy of the completed form for your records

(2) I/We ~~Mr~~ Dotapo Dorcas Ayemi Mufutau ADEYEMI

apply for a premises licence under section 17 the Licensing Act 2003 for the premises described in Part 1 below (the premises) and I/we are making this application to you as the relevant licensing authority in accordance with section 12 of the Licensing Act 2003

Part 1 - Premises details

Postal address of premises or, if none, Ordnance Survey map reference or description 77, West Green road, Tottenham, N15 5DA TIWA 'N' TIWA african Restaurant	
Post town Tottenham	Postcode N15 5DA

Telephone number at premises(if any) 0744 896 3313

Non-domestic rateable value of premises £

Part 2 - Applicant details

Please state whether you are applying for a premises licence as

- Please tick yes
- a) an individual or individuals* please complete section (A)
 - b) a person other than an individual*
 - i. as a limited company please complete section (B)
 - ii. as a partnership please complete section (B)
 - iii. as an unincorporated association; or please complete section (B)
 - iv. other (for example a statutory corporation) please complete section (B)

(1) Insert name and address of relevant licensing authority and its reference number (optional)
(2) Insert name(s) of applicant

- c) a recognised club please complete section (B)
- d) a charity please complete section (B)
- e) the proprietor of an educational establishment please complete section (B)
- f) a health service body please complete section (B)
- g) a person who is registered under Part 2 of the Care Standards Act 2000 (c14) in respect of an independent hospital please complete section (B)
- h) the chief officer of police of a police force in England and Wales please complete section (B)

* If you are applying as a person described in (a) or (b) please confirm:

- I am carrying on or proposing to carry on a business which involves the use of the premises for licensable activities; or Please tick yes
- I am making the application pursuant to
 - a statutory function; or
 - a function discharged by virtue of Her Majesty's prerogative

(A) INDIVIDUAL APPLICANTS (fill in as applicable)

Mr Mrs Miss Ms Other title
 (for example, Rev)

Surname First names

I am 18 years old or over Please tick yes Date of birth

Day	Month	Year

Current postal address if different from premises address

Post town Postcode

Daytime contact telephone number

E-mail address (optional)

SECOND INDIVIDUAL APPLICANT (if applicable)

Mr

Mrs

Miss

Ms

Other title
(for example, Rev)

Surname

First names

I am 18 years old or over

Please tick yes

Date of birth

Day	Month	Year
<input type="text" value="12"/>	<input type="text" value="1"/>	<input type="text" value="7 2 1"/>

Current postal address if different from premises address

Post town

Postcode

Daytime contact telephone number

E-mail address
(optional)

(B) OTHER APPLICANTS

Please provide name and registered address of applicant in full. Where appropriate please give any registered number. In the case of a partnership or other joint venture (other than a body corporate), please give the name and address of each party concerned.

Name
Address
Registered number (where applicable)
Description of applicant (for example partnership, company, unincorporated association etc.)
Telephone number (if any)
E-mail address (optional)

Part 3 - Operating Schedule

When do you want the premises licences to start?

Day	Month	Year
01	09	2016

If you wish the licence to be valid only for a limited period, when do you want it to end?

Day	Month	Year

Please give a general description of the premises (please read guidance note 1)

Full Description as per the attached Diagram
mark as Exhibit A

If 5,000 or more people are expected to attend the premises at any one time, please state the number expected to attend

--

What licensable activities do you intend to carry on from the premises?
(Please see sections 1 and 14 of the Licensing Act 2003 and Schedule 1 and 2 to the Licensing Act 2003)

Provision of regulated entertainment

- | | |
|--|--|
| a) plays (if ticking yes, fill in box A) | Please tick <input type="checkbox"/> yes |
| b) films (if ticking yes, fill in box B) | <input type="checkbox"/> |
| c) indoor sporting events (if ticking yes, fill in box C) | <input type="checkbox"/> |
| d) boxing or wrestling entertainment (if ticking yes, fill in box D) | <input type="checkbox"/> |
| e) live music (if ticking yes, fill in box E) | <input type="checkbox"/> |
| f) recorded music (if ticking yes, fill in box F) | <input checked="" type="checkbox"/> |
| g) performances of dance (if ticking yes, fill in box G) | <input type="checkbox"/> |
| h) anything of a similar description to that falling within (e), (f) or (g)
(if ticking yes, fill in box H) | <input type="checkbox"/> |

Provision of entertainment facilities for:

- | | |
|--|--------------------------|
| i) making music (if ticking yes, fill in box I) | <input type="checkbox"/> |
| j) dancing (if ticking yes, fill in box J) | <input type="checkbox"/> |
| k) entertainment of a similar description to that falling within (i) or (j)
(if ticking yes, fill in box K) | <input type="checkbox"/> |

Provision of late night refreshment (if ticking yes, fill in box L)

Supply of alcohol (if ticking yes, fill in box M)

In all cases complete boxes N, O and P

A

Plays			Will the performance of a play take place indoors or outdoors or both - please tick <input checked="" type="checkbox"/> (please read guidance note 2)
Day	Start	Finish	
Mon			Indoors <input type="checkbox"/> Outdoors <input type="checkbox"/> Both <input type="checkbox"/>
Tue			Please give further details here (please read guidance note 3)
Wed			State any seasonal variations for performing plays (please read guidance note 4)
Thur			
Fri			Non-standard timings. Where you intend to use the premises for the performance of plays at different times from those listed in the column on the left, please list (please read guidance note 5)
Sat			
Sun			

B

Films			Will the exhibition of films take place indoors or outdoors or both - please tick <input checked="" type="checkbox"/> (please read guidance note 2)
Day	Start	Finish	
Mon			Indoors <input type="checkbox"/> Outdoors <input type="checkbox"/> Both <input type="checkbox"/>
Tue			Please give further details here (please read guidance note 3)
Wed			State any seasonal variations for the exhibition of films (please read guidance note 4)
Thur			
Fri			Non-standard timings. Where you intend to use the premises for the exhibition of films at different times from those listed in the column on the left, please list (please read guidance note 5)
Sat			
Sun			

C

Indoor sporting events			Please give further details here (please read guidance note 3)
Standard days and timings (please read guidance note 6)			
Day	Start	Finish	State any seasonal variations for indoor sporting events (please read guidance note 4)
Mon			
Tue			
Wed			
Thur			
			Non-standard timings. Where you intend to use the premises for indoor sporting events at different times from those listed in the column on the left, please list (please read guidance note 5)
Fri			
Sat			
Sun			

D

Boxing or wrestling entertainments			Will the boxing or wrestling entertainment take place indoors or outdoors or both - please tick <input checked="" type="checkbox"/> (please read guidance note 2)
Standard days and timings (please read guidance note 6)			
Day	Start	Finish	Indoors <input type="checkbox"/> Outdoors <input type="checkbox"/> Both <input type="checkbox"/>
Mon			Please give further details here (please read guidance note 3)
Tue			State any seasonal variations for boxing or wrestling entertainment (please read guidance note 4)
Wed			
Thur			
Fri			
Sat			
Sun			

E

Live music			Will the performance of live music take place indoors or outdoors or both - please tick <input checked="" type="checkbox"/> (please read guidance note 2)
Day	Start	Finish	
Mon			Indoors <input type="checkbox"/> Outdoors <input type="checkbox"/> Both <input type="checkbox"/>
Tue			Please give further details here (please read guidance note 3)
Wed			State any seasonal variations for the performance of live music (please read guidance note 4)
Thur			
Fri			Non-standard timings. Where you intend to use the premises for the performance of live music at different times from those listed in the column on the left, please list (please read guidance note 5)
Sat			
Sun			

F

Recorded music			Will the playing of recorded music take place indoors or outdoors or both - please tick <input checked="" type="checkbox"/> (please read guidance note 2)
Day	Start	Finish	
Mon	12 Noon	10 pm	Indoors <input checked="" type="checkbox"/> Outdoors <input type="checkbox"/> Both <input type="checkbox"/>
Tue	12 Noon	10 pm	Please give further details here (please read guidance note 3)
Wed	12 Noon	10 pm	State any seasonal variations for the playing of recorded music (please read guidance note 4)
Thur	12 Noon	10 pm	
Fri	12 Noon	02 AM	Non-standard timings. Where you intend to use the premises for the playing of recorded music entertainment at different times from those listed in the column on the left, please list (please read guidance note 5)
Sat	12 Noon	02 AM	
Sun	12 Noon	02 AM	

G

Performances of dance Standard days and timings (please read guidance note 6)			Will the performance of dance take place indoors or outdoors or both - please tick <input checked="" type="checkbox"/> (please read guidance note 2)
Day	Start	Finish	
Mon			Indoors <input type="checkbox"/> Outdoors <input type="checkbox"/> Both <input type="checkbox"/>
Tue			Please give further details here (please read guidance note 3)
Wed			State any seasonal variations for the performance of dance (please read guidance note 4)
Thur			
Fri			Non-standard timings. Where you intend to use the premises for the performance of dance entertainment at different times from those listed in the column on the left, please list (please read guidance note 5)
Sat			
Sun			

H

Anything of a similar description to that falling within (e), (f) or (g) Standard days and timings (please read guidance note 6)			Please give a description of the type of entertainment you will be providing
Day	Start	Finish	
Mon			Will this entertainment take place indoors or outdoors or both - please tick <input checked="" type="checkbox"/> (please read guidance note 2)
Tue			Indoors <input type="checkbox"/> Outdoors <input type="checkbox"/> Both <input type="checkbox"/>
Wed			Please give further details here (please read guidance note 3)
Thur			State any seasonal variations for entertainment of a similar description to that falling within (e), (f) or (g) (please read guidance note 4)
Fri			
Sat			Non-standard timings. Where you intend to use the premises for the entertainment of similar description to that falling within (e), (f) or (g) at different times from those listed in the column on the left, please list (please read guidance note 5)
Sun			

Provision of facilities for making music			Please give a description of the facilities for making music you will be providing
Standard days and timings (please read guidance note 6)			
Day	Start	Finish	Will the facilities for making music be indoors or outdoors or both - please tick <input checked="" type="checkbox"/> (please read guidance note 2) Indoors <input type="checkbox"/> Outdoors <input type="checkbox"/> Both <input type="checkbox"/>
Mon			
Tue			State any seasonal variations for the provision of facilities for making music (please read guidance note 4)
Wed			Non-standard timings. Where you intend to use the premises for provision of facilities for making music at different times from those listed in the column on the left, please list (please read guidance note 5)
Thur			
Fri			
Sat			
Sun			

J

Provision of facilities for dancing			Please give a description of the facilities for dancing you will be providing
Standard days and timings (please read guidance note 6)			
Day	Start	Finish	Will the facilities for dancing be indoors or outdoors or both - please tick <input checked="" type="checkbox"/> (please read guidance note 2) Indoors <input type="checkbox"/> Outdoors <input type="checkbox"/> Both <input type="checkbox"/>
Mon			
Tue			State any seasonal variations for providing dancing facilities (please read guidance note 4)
Wed			Non-standard timings. Where you intend to use the premises for the provision of facilities for dancing entertainment at different times from those listed in the column of the left, please list (please read guidance note 5)
Thur			
Fri			
Sat			
Sun			

K

Provision of facilities for entertainment of a similar description to that falling within I or J			Please give a description of the type of entertainment facility you will be providing
Standard days and timings (please read guidance note 6)			Will the entertainment facility be indoors or outdoors or both - please tick <input checked="" type="checkbox"/> (please read guidance note 2)
Day	Start	Finish	Indoors <input type="checkbox"/> Outdoors <input type="checkbox"/> Both <input type="checkbox"/>
Mon			Please give further details here (please read guidance note 3)
Tue			State any seasonal variations for the provision of facilities for entertainment of a similar description to that falling within I or J (please read guidance note 4)
Wed			Non-standard timings. Where you intend to use the premises for the provision of facilities for entertainment of a similar description to that falling within I or J at different times from those listed in the column on the left, please list (please read guidance note 5)
Thur			
Fri			
Sat			
Sun			

L

Late night refreshment			Will the provision of late night refreshment take place indoors or outdoors or both - please tick <input checked="" type="checkbox"/> (please read guidance note 2)
Day	Start	Finish	
Mon			Indoors <input type="checkbox"/> Outdoors <input type="checkbox"/> Both <input type="checkbox"/>
Tue			Please give further details here (please read guidance note 3)
Wed			State any seasonal variations for the provision of late night refreshment (please read guidance note 4)
Thur			
Fri			Non-standard timings. Where you intend to use the premises for the provision of late night refreshment at different times from those listed in the column on the left, please list (please read guidance note 5)
Sat			
Sun			

M

Supply of alcohol			Will the sale of alcohol be for consumption - please tick box <input checked="" type="checkbox"/> (please read guidance note 7)
Day	Start	Finish	
Mon	12 noon	12 pm	On the premises <input type="checkbox"/> Off the premises <input type="checkbox"/> Both <input checked="" type="checkbox"/>
Tue	12 noon	12 pm	State any seasonal variations for the supply of alcohol (please read guidance note 4)
Wed	12 noon	12 pm	ALL SEASONS and ALL YEAR ROUND EXCEPT ON CHRISTMAS & NEW YEAR DAY
Thur	12 noon	12 pm	Non-standard timings. Where you intend to use the premises for the supply of alcohol at different times from those listed in the column on the left, please list (please read guidance note 5)
Fri	12 noon	02 am	
Sat	12 noon	02 am	
Sun	12 noon	02 am	

State the name and details of the individual whom you wish to specify on the licence as premises supervisor

Name **Mr. Mufutan Adeleye ADEYEMI**

Address

Postcode

Personal Licence number (if known) **13/00239/BEXLEY/L1**

Issuing licensing authority (if known) **LONDON BOROUGH OF BEXLEY**

N

Please highlight any adult entertainment or services, activities, other entertainment or matters ancillary to the use of the premises that may give rise to concern in respect of children (please read guidance note 8)

Serving and provision of Alcohol and late night refreshment. Recorded music will also be played for light entertainment of guests and customers.

O

Hours premises are open to the public

Standard days and timings (please read guidance note 6)

Day	Start	Finish
Mon	12 NOON	12 pm
Tue	12 NOON	12 pm
Wed	12 NOON	12 pm
Thur	12 NOON	12 pm
Fri	12 NOON	02 Am
Sat	12 NOON	02 Am
Sun	12 NOON	02 Am

State any seasonal variations (please read guidance note 4)

Non-standard timings. Where you intend to use the premises to be open to the public at different times from those listed in the column on the left, please list (please read guidance note 5)

P Describe the steps you intend to take to promote the four licensing objectives:

a) General - all four licensing objectives (b, c, d, e) (please read guidance note 9)

On the premises, there will be at all times a designated premises supervisor (DPS) or a well trained personnel for the sale and serving of Alcohol by the DPS.

Sound prove wall is installed to take care of any noise pollution.

b) The prevention of crime and disorder

CCTV will be installed

c) Public safety

Ensure a clean, ~~and visible~~ well lit visible pathways both in and outside the premises.

d) The prevention of public nuisance

DPS will ensure no alcohol is served to children, or person below the age of 18 by demanding for Identity before services and that no service policy for drunkard ~~and~~ who in the judgment of the DPS is perceived to have been drunk.

e) The protection of children from harm

NO ID - NO Service policy.

CHECKLIST:

- I have made or enclosed payment of the fee
- I have enclosed the plan of the premises
- I have sent copies of this application and the plan to responsible authorities and others where applicable
- I have enclosed the consent form completed by the individual I wish to be premises supervisor, if applicable
- I understand that I must now advertise my application
- I understand that if I do not comply with the above requirements my application will be rejected

Please tick ✓

IT IS AN OFFENCE, LIABLE ON CONVICTION TO A FINE UP TO LEVEL 5 ON THE STANDARD SCALE, UNDER SECTION 158 OF THE LICENSING ACT 2003 TO MAKE A FALSE STATEMENT IN OR IN CONNECTION WITH THIS APPLICATION

Part 4 - Signatures (please read guidance note 10)

Signature of applicant or applicant's solicitor or other duly authorised agent. (Please read guidance note 11)
If signing on behalf of the applicant please state in what capacity.

Signature 

Date 17/08/2016

Capacity Proprietor

For joint applications signature of 2nd applicant, 2nd applicant's solicitor or other authorised agent.
(Please read guidance note 12)
If signing on behalf of the applicant please state in what capacity.

Signature

Date

Capacity

Contact name (where not previously given) and postal address for correspondence associated with this application (please read guidance note 13)

Post town

Postcode

Telephone number (if any)

If you would prefer us to correspond with you by e-mail your e-mail address (optional)

West Green Road, London, N15

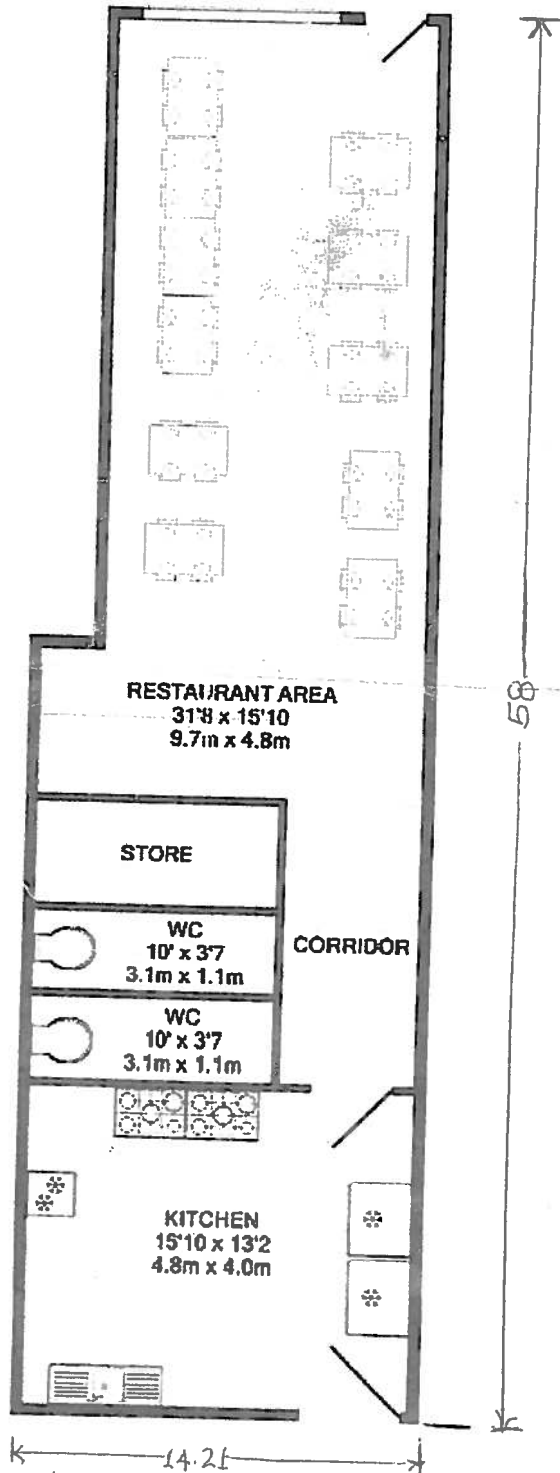

WEST GREEN ROAD, TOTTENHAM, N15 5DA
TOTAL APPROX. FLOOR AREA 824 SQ.FT. (76.6 SQ.M.)

Whilst every attempt has been made to ensure the accuracy of the floor plan contained here, measurements of doors, windows, rooms and any other items are approximate and no responsibility is taken for any error, omission or mis-statement. This plan is for illustrative purposes only and should be used as such by any prospective purchaser. The services, systems and appliances shown have not been tested and no guarantee is to their operability or efficiency can be given.
Made with Metacax 1/2016

Scale of 1:100

Appendix 2 – Copy of Representations

Anderson Chanel

From:
Sent: 01 November 2016 13:30
To: Licensing
Subject: Representation - Tiwa n Tiwa restaurant application

Representation on licence application for:

Tiwa 'N' Tiwa African Restaurant

77 West Green Road, Tottenham, London, N15 5DA.

The prevention of crime and disorder/public nuisance

The West Green Road has been a 'sensitive' area for many years and the Council's efforts since the riots (more cameras, upgrading shop fronts, communal garden, etc) have had a positive impact on the local community here. However, there are still regular occurrences of violence and abusive behaviour, and gatherings on the street, particularly at night/early hours of the morning.

As an example, When the Fountain pub (1.30-2.00am on Fridays/Saturdays) closes, a stream of people can be heard shouting, singing and sometimes fighting, cars revving their engines hard, racing, urinating and vomiting. If this premises had their hours extended to 2am, it would simply act as another venue for these people to go to, creating a new centre (club not a restaurant) for determined drinkers from all over the locality.

This part of West Green Road has residential accommodation and also above shops/takeaways. Nearly all the shops operate between normal hours. A club (what it becomes at that hour) operating to 2am would generate disturbing and intrusive levels of noise from music, talking/shouting, people traffic (coming and going), noise of cars parking/leaving all night/morning.

The area is improving rapidly, with new flats at Lawrence Square (30 metres away) mainly housing families, this is the kind of neighbourhood I want to live in, not one dominated by clubs offering loud music and alcohol until 2am. It would be a big step backwards and undo the Council's good work here.

Public safety

During the day and night, the presence of customers standing on the street, smoking and intoxicated will cause people to avoid the vicinity, especially mothers with children and the elderly. There are a lot of obviously heavy drinkers in the area and encouraging these people is again a complete step backwards and compromises public safety. The increase in traffic will also put safety at risk in an already busy area.

Protection of children from harm

The area is becoming a better place for children to grow up in, the idea of having a club selling alcohol, purveying loud/club music and resultant anti-social behaviour on their doorstep, next to their homes, where they walk to and from school, does not create a good and safe environment for children.

I, hereby declare that all information I have submitted is true and correct.

Date:1/11/2016.....

This email has been scanned by the Symantec Email Security.cloud service.
For more information please visit <http://www.symanteccloud.com>